



Via della Cupola, 239 - 50145 FIRENZE

Centr. 055 34 30 511 - Fax 055 34 30 522

E-mail: commerciale@vicinitubi.com

www.vicinitubi.com

PROFILI APERTI RICAVATI DA LAMIERA PIEGATA A FREDDO

PROFILO SAGOMATO AD L

DIMENSIONI ESTERNE	SPESSORI - PESO Kg/m				
	1,5	2,0	2,5	3,0	4,0
8 x 8 x 8	0,21				
10 x 10 x 10	0,29				
12 x 12 x 12	0,36				
14 x 14 x 14	0,43				
15 x 15 x 15	0,47	0,59			
10 x 15 x 10	0,25	0,35			
10 x 20 x 10	0,41				
20 x 20 x 20	0,65	0,82			
25 x 20 x 25	0,77	0,99			
30 x 20 x 30	0,89	1,15			
35 x 20 x 35	1,00	1,31			
40 x 20 x 40	1,13	1,47			
25 x 25 x 25	0,83	1,07	1,30		
30 x 25 x 30	0,95	1,17			
35 x 25 x 35	1,07	1,39			
40 x 25 x 40	1,19	1,55			
10 x 30 x 10	0,53	0,67			
15 x 30 x 15	0,65	0,83			
20 x 30 x 20	0,77	0,99	1,20		
35 x 30 x 35	1,13	1,47	1,80	2,11	
40 x 30 x 40	1,25	1,63	2,00	2,35	
35 x 35 x 35	1,20	1,55		2,28	
20 x 40 x 20	0,89	1,15	1,40	1,63	
30 x 40 x 30	1,13	1,47	1,80	2,11	2,68
40 x 40 x 40	1,37	1,79	2,20	2,59	3,33
25 x 50 x 25	1,13	1,47	1,80	2,11	2,69
30 x 50 x 30	1,25	1,63	2,00	2,35	3,01
50 x 50 x 50		2,28	3,31	4,29	
20 x 60 x 20	1,13	1,47	1,80	2,11	
30 x 60 x 30	1,37	1,79	2,20	2,59	3,33
40 x 60 x 40	1,61	2,11	2,60	3,07	3,97
60 x 60 x 60		2,76	3,40	4,04	5,25
30 x 70 x 30		1,95	2,40	2,88	
30 x 80 x 30	1,61	2,11	2,60	3,07	3,97
40 x 80 x 40	1,85	2,43	3,00	3,55	4,61
45 x 90 x 45		2,75	3,40	4,03	5,25
40 x 100 x 40	2,09	2,75	3,40	4,03	5,25
50 x 100 x 50	2,33	3,07	3,80	4,51	5,89
60 x 100 x 60		3,39	4,20	4,99	6,53
50 x 110 x 50	2,45	3,23	4,00	4,75	6,21
60 x 110 x 60		3,39	4,20	4,99	6,53
60 x 120 x 60		3,71	4,60	5,47	7,17
60 x 140 x 60		4,03	5,00	5,95	7,81
70 x 140 x 70				6,44	8,50
50 x 150 x 50	2,93	3,87	4,80	5,71	7,49
60 x 180 x 60				6,78	8,90
100 x 200 x 100				9,31	12,2

ANGOLARE A LATI UGUALI

DIMENSIONI ESTERNE	SPESSORI - PESO Kg/m				
	1,5	2,0	2,5	3,0	4,0
10 x 10	0,20				
15 x 15	0,32	0,41			
20 x 20	0,43	0,56	0,72	0,84	
25 x 25	0,55	0,72	0,90	1,06	
30 x 30	0,67	0,88	1,10	1,25	
35 x 35	0,82	1,03	1,30	1,53	
40 x 40	0,94	1,20	1,45	1,75	2,30
45 x 45		1,35	1,69	2,00	2,63
50 x 50		1,51	1,87	2,20	2,95
60 x 60			2,27	2,70	3,50
70 x 70			2,74	3,15	4,15
80 x 80				3,65	4,76
90 x 90				4,12	5,46
100 x 100					6,00

ANGOLARE A LATI DISUGUALI

DIMENSIONI ESTERNE	SPESSORI - PESO Kg/m				
	1,5	2,0	2,5	3,0	4,0
20 x 10	0,33				
30 x 10	0,45				
30 x 15	0,50	0,66	0,83	0,99	
30 x 20	0,56	0,75	0,93	1,10	
40 x 20	0,68	0,94	1,14	1,34	
50 x 20		1,06	1,32	1,56	
50 x 25		1,15	1,42	1,70	
50 x 30		1,22	1,52	1,81	
60 x 20		1,22	1,52	1,81	
60 x 30		1,46	1,72	2,04	
60 x 40		1,53	1,90	2,25	2,94
70 x 35			2,00	2,37	
80 x 40			2,30	2,73	3,58
80 x 60				3,21	4,22
90 x 45				3,09	4,06
100 x 50				3,45	4,54

PROFILATI A RICHIESTA SU MISURA DIMENZIONI E LUNGHEZZA

ROTAIA PER PORTONI

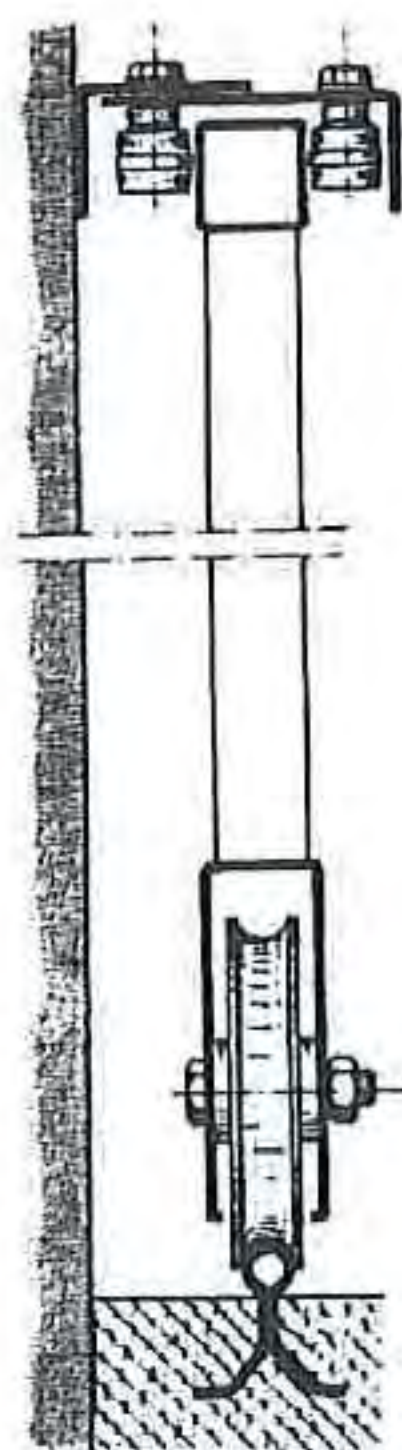
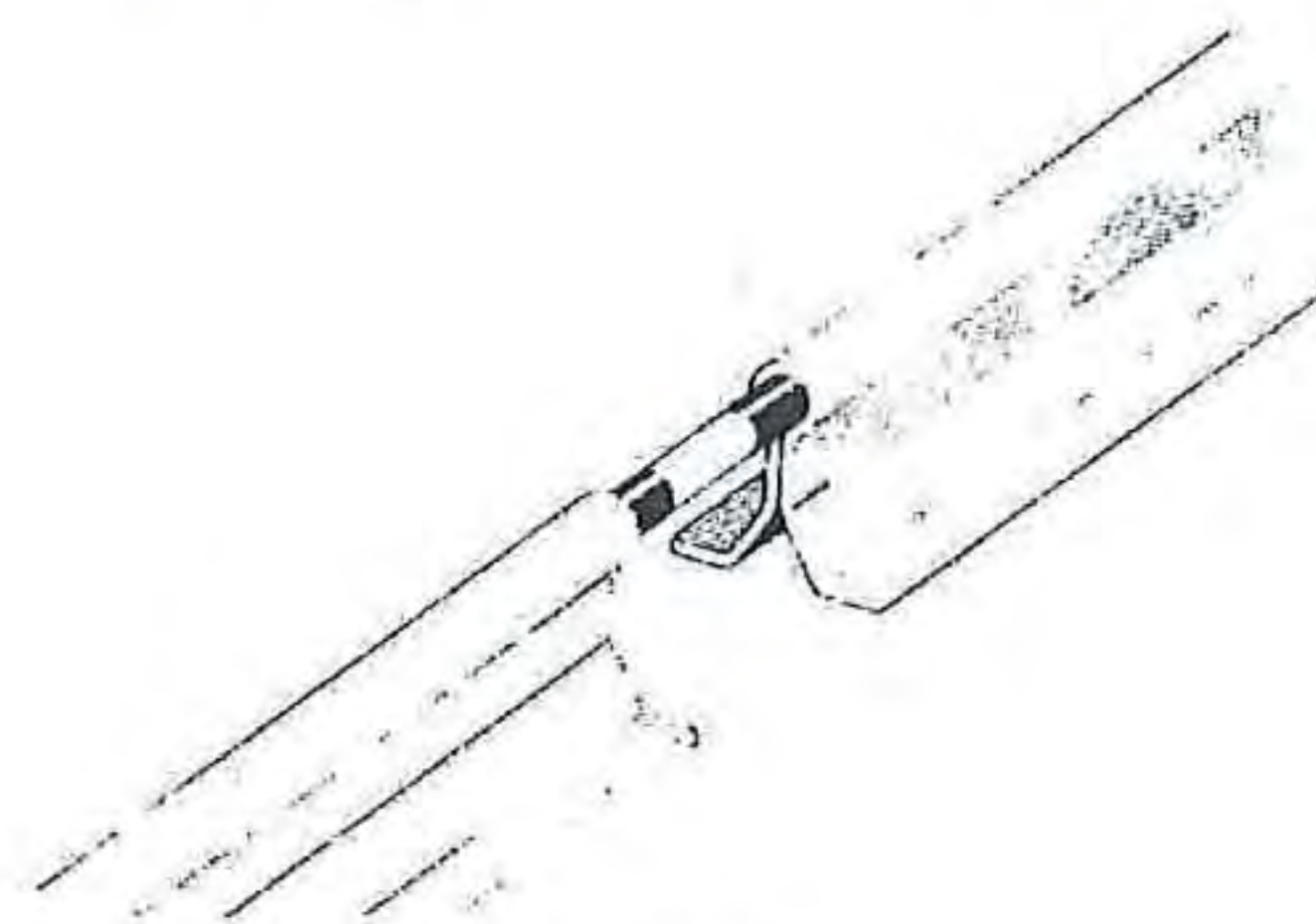
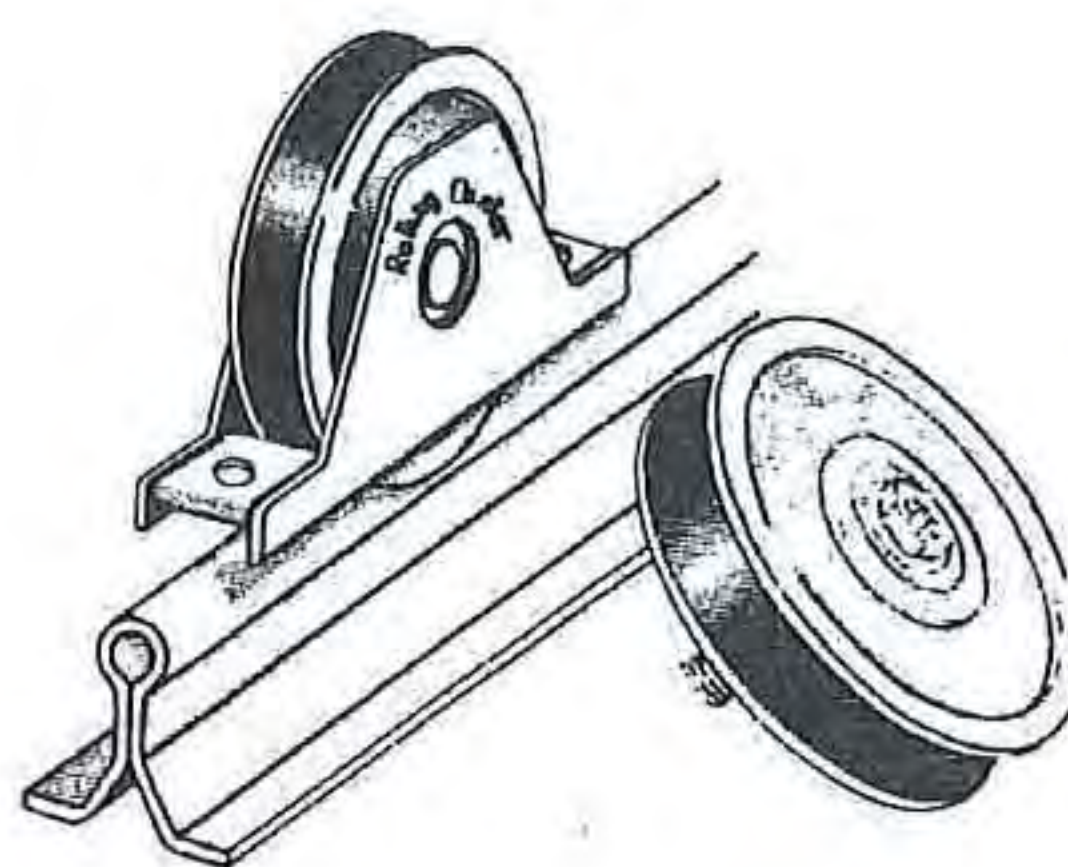

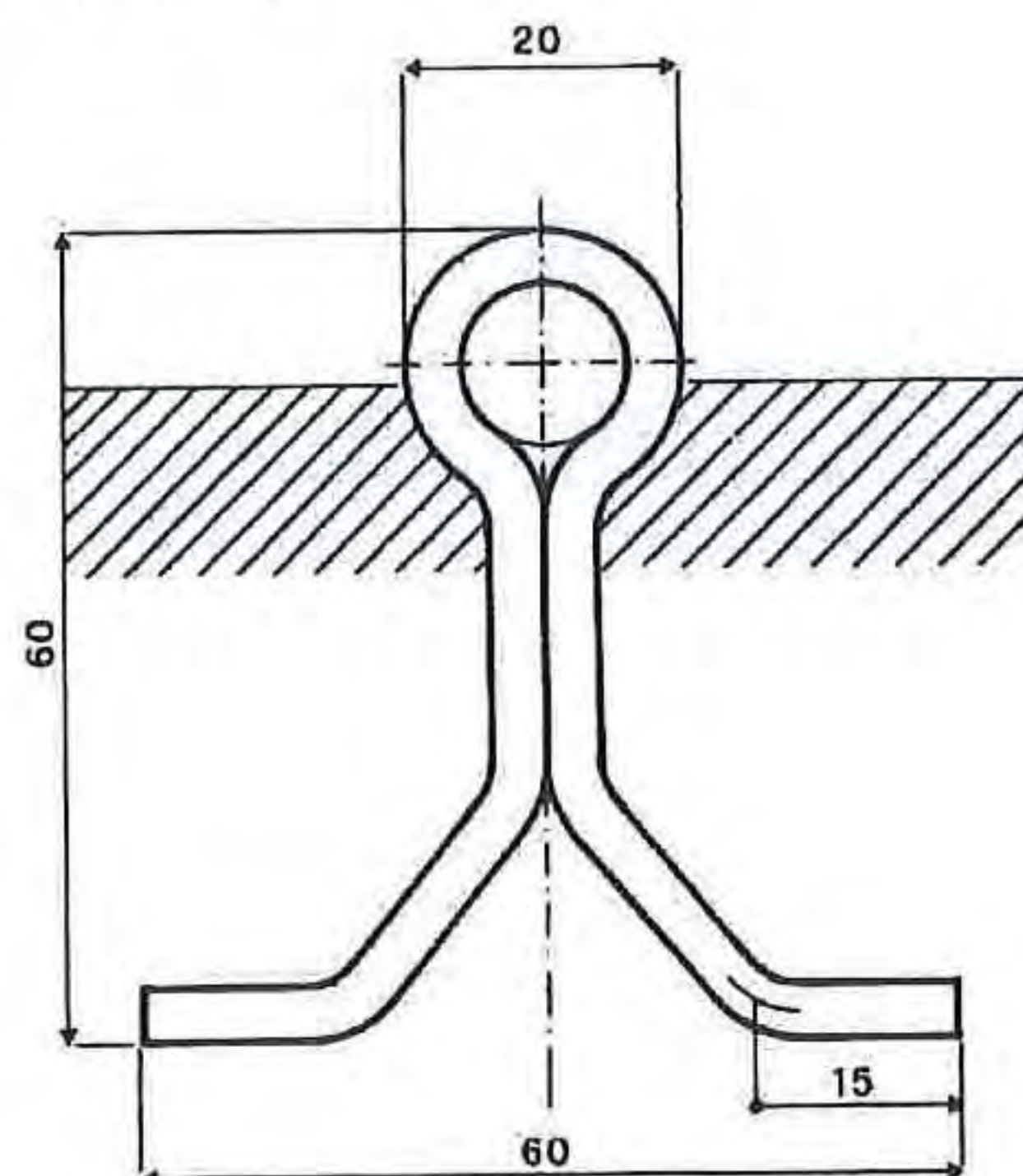

- INSTALLAZIONE PIU' SEMPLICE E PIU' RAPIDA
- ELIMINAZIONE DELLA FASE MECCANICA DI COSTRUZIONE DEL BINARIO
- ELIMINAZIONE SFRIDI E SALDATURE
- LUNGHEZZE MODULARI A PIACERE ACCOPPIAMENTO PERFETTO ED INSTANTANEO
- SCORRIMENTO ECCEZIONALMENTE FACILE PER RIDURRE AL MASSIMO L'ATRITO
- PRONTO ALL'USO, GIA' GALVANIZZATO
- PESO = 4,6 Kg/m: UN SOLO MODELLO PER TUTTI I CARICHI
- COSTO RIDOTTO PER UN RISULTATO DI QUALITA' DAVVERO SUPERIORE

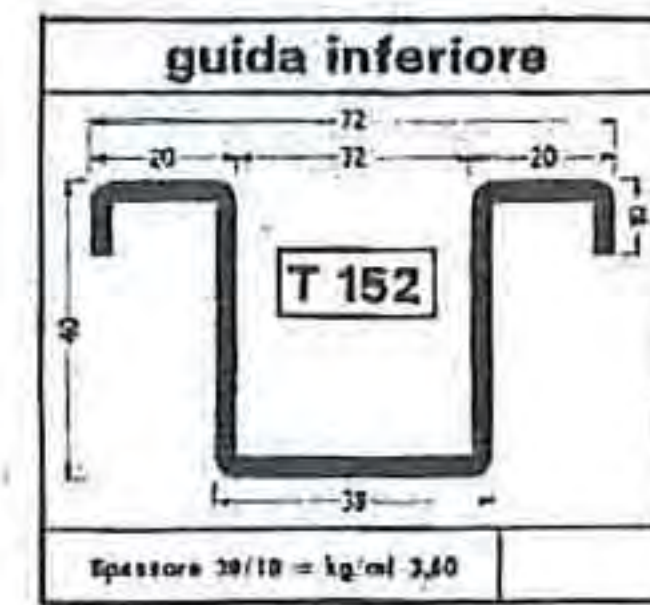
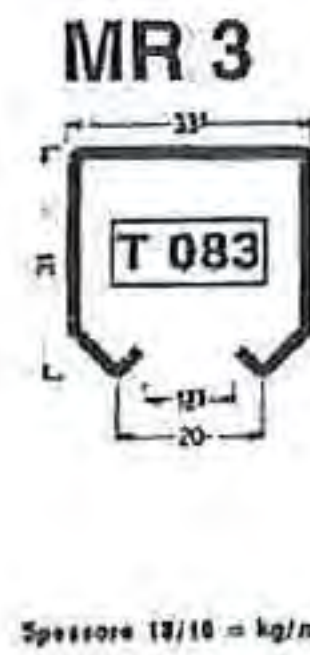

monorotaie

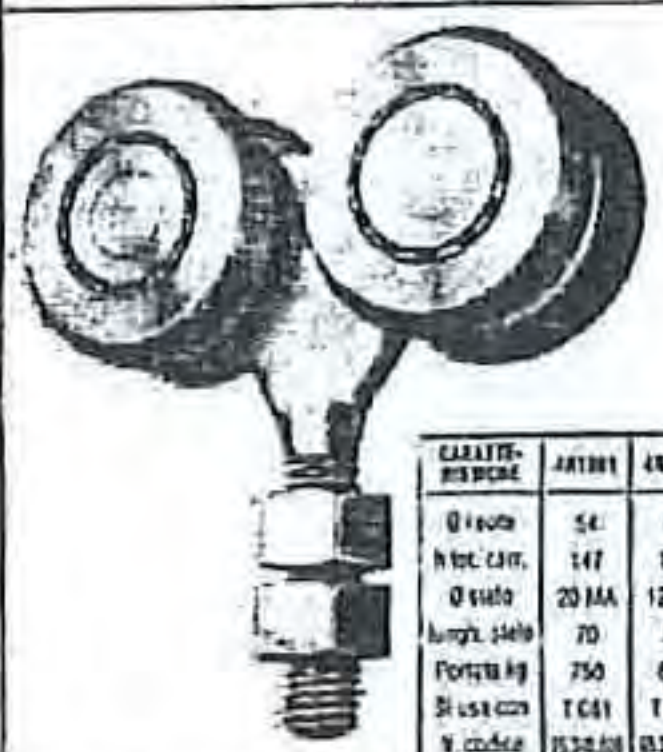
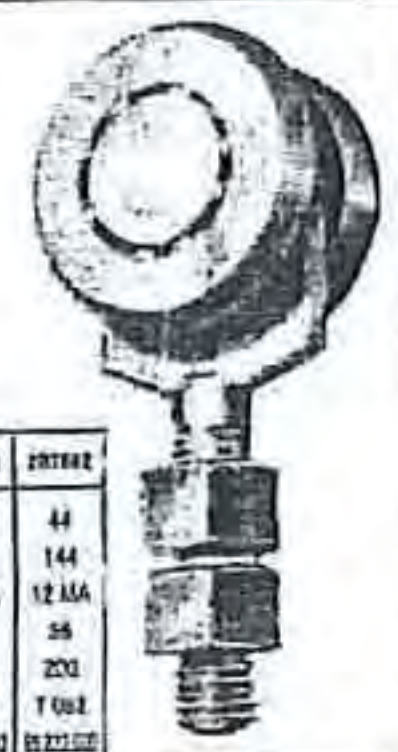

carrelli per monorotaie con gambo fisso

4RT081 4RT082 4RPP/T083		2RT081 2RT082 2RPP/T083		4RMLI																																																							
																																																											
<table border="1"> <thead> <tr> <th>CARATTERISTICA</th> <th>4RT081</th> <th>4RT082</th> <th>2RT081</th> <th>2RT082</th> </tr> </thead> <tbody> <tr> <td>Ø ruote</td> <td>54</td> <td>64</td> <td>54</td> <td>64</td> </tr> <tr> <td>h. tot. carr.</td> <td>147</td> <td>115</td> <td>132</td> <td>144</td> </tr> <tr> <td>Ø stelo</td> <td>20 MA</td> <td>12 MA</td> <td>20 MA</td> <td>12 MA</td> </tr> <tr> <td>lung. stelo</td> <td>70</td> <td>58</td> <td>75</td> <td>58</td> </tr> <tr> <td>Portata kg</td> <td>750</td> <td>650</td> <td>400</td> <td>200</td> </tr> <tr> <td>Di. ass. con</td> <td>T 081</td> <td>T 082</td> <td>T 081</td> <td>T 082</td> </tr> <tr> <td>N. codice</td> <td>0524.008</td> <td>0514.009</td> <td>0521.003</td> <td>0521.002</td> </tr> </tbody> </table>		CARATTERISTICA	4RT081	4RT082	2RT081	2RT082	Ø ruote	54	64	54	64	h. tot. carr.	147	115	132	144	Ø stelo	20 MA	12 MA	20 MA	12 MA	lung. stelo	70	58	75	58	Portata kg	750	650	400	200	Di. ass. con	T 081	T 082	T 081	T 082	N. codice	0524.008	0514.009	0521.003	0521.002	<table border="1"> <thead> <tr> <th>CARATTERISTICA</th> <th>4RMLI</th> </tr> </thead> <tbody> <tr> <td>Ø diametro ruote</td> <td>mm 23</td> </tr> <tr> <td>Altezza totale carrello</td> <td>mm 63</td> </tr> <tr> <td>Spessore attacco</td> <td>mm 8</td> </tr> <tr> <td>Lunghezza assiale</td> <td>mm 21</td> </tr> <tr> <td>Portata kg</td> <td>50</td> </tr> <tr> <td>Di. ass. con</td> <td>T085</td> </tr> <tr> <td>N. codice</td> <td>55.241.009.00</td> </tr> </tbody> </table>		CARATTERISTICA	4RMLI	Ø diametro ruote	mm 23	Altezza totale carrello	mm 63	Spessore attacco	mm 8	Lunghezza assiale	mm 21	Portata kg	50	Di. ass. con	T085	N. codice	55.241.009.00
CARATTERISTICA	4RT081	4RT082	2RT081	2RT082																																																							
Ø ruote	54	64	54	64																																																							
h. tot. carr.	147	115	132	144																																																							
Ø stelo	20 MA	12 MA	20 MA	12 MA																																																							
lung. stelo	70	58	75	58																																																							
Portata kg	750	650	400	200																																																							
Di. ass. con	T 081	T 082	T 081	T 082																																																							
N. codice	0524.008	0514.009	0521.003	0521.002																																																							
CARATTERISTICA	4RMLI																																																										
Ø diametro ruote	mm 23																																																										
Altezza totale carrello	mm 63																																																										
Spessore attacco	mm 8																																																										
Lunghezza assiale	mm 21																																																										
Portata kg	50																																																										
Di. ass. con	T085																																																										
N. codice	55.241.009.00																																																										

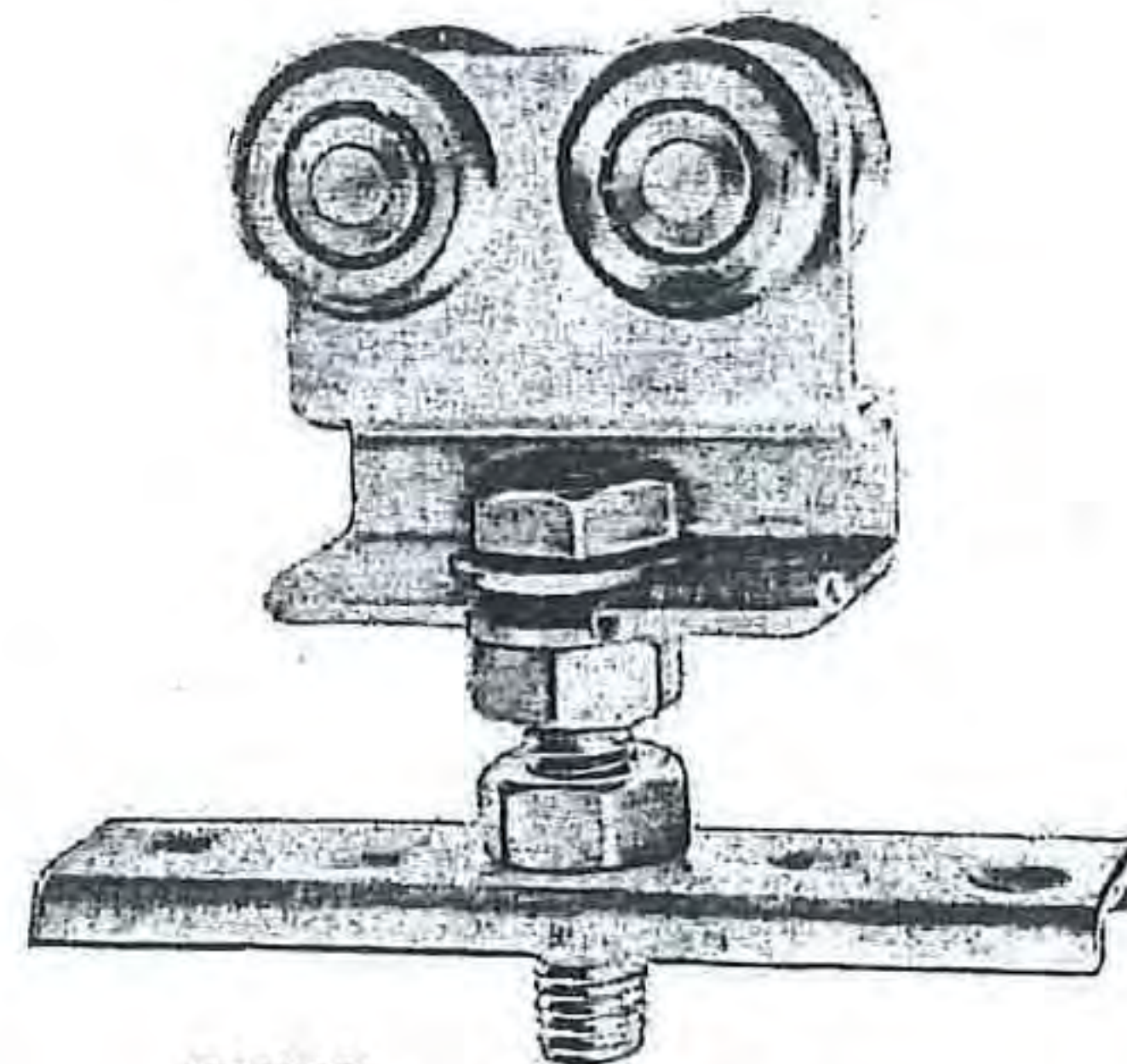
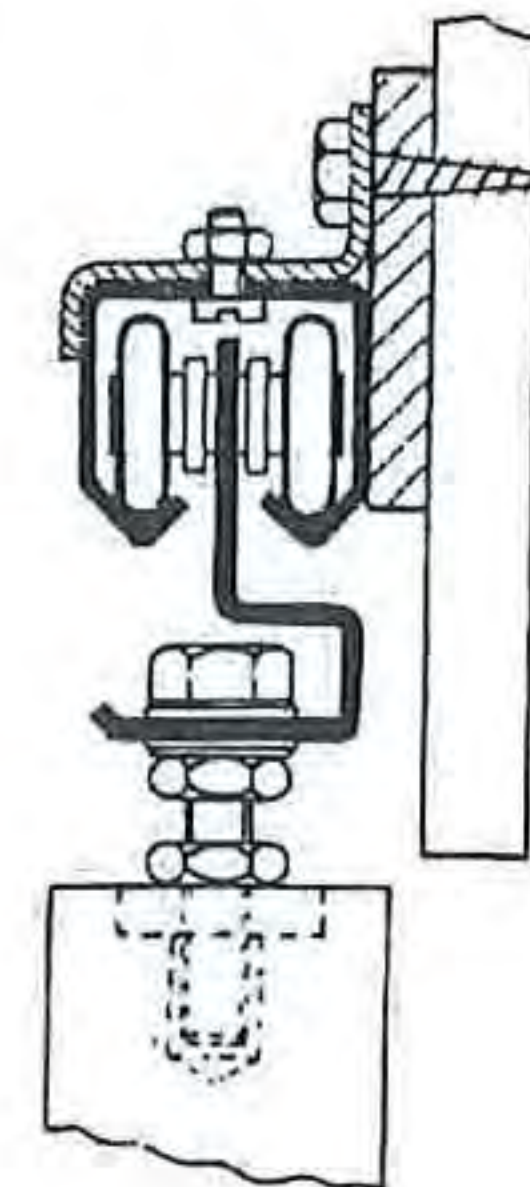

2RT083
 Carrello a 2 ruote
 Corpo in lamiera stampata, zincata
 Ruote in acciaio, tornite e cementate

4RT083
 Carrello a 4 ruote
 Corpo in lamiera stampata, zincata
 Ruote in acciaio, tornite e cementate

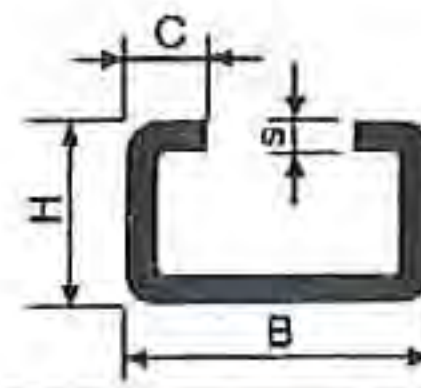

Via della Cupola, 239 - 50145 FIRENZE
 Centr. 055 34 30 511 - Fax 055 34 30 522
 E-mail: commerciale@vicinitubi.com
 www.vicinitubi.com

dimensioni			spessore in mm							
B	H	C	1	1.2	1.5	2	2.5	3	3.5	4
20	20	6	0.53	0.63						
25	15	7.5		0.61	0.74	0.96				
25	25	7.5		0.80	0.99					
30	10	10		0.62	0.75					
30	15	7.5		0.66	0.81					
30	17	9				1.16	1.41			
30	30	10			1.22	1.60	1.96	2.38		
30	40	10			1.46	1.92	2.36			
30	60	10					3.14	3.72		
35	11	7		0.76	0.99					
35	35	10				2.25	2.66			
38	20	8		0.84	1.04					
40	20	10		0.90	1.11	1.33				
40	20	12					1.84	2.17		

(seguito)

dimensioni			spessore in mm							
B	H	C	1	1.2	1.5	2	2.5	3	3.5	4
40	30	15		1.18	1.46					
40	40	10			1.58	2.07				
40	40	15				2.23	2.75	3.25		
40	50	15				2.54	3.14			
45	40	15				2.31	2.84			
45	45	15		1.51	1.87					
45	45	17.5			1.93	2.54				
50	10	8.5	0.65	0.78						
50	12	17.5			1.21	1.59				
50	17	17.5		1.08	1.33					
50	30	7.5		1.13	1.40					
50	25	12			1.39	1.82				
50	30	10					2.35	2.78		
50	30	15			1.58	2.07				
50	30	20				2.17	2.75	3.25		
50	40	15		1.81	2.39					
50	40	20					3.14	3.72		
50	45	15			1.93	2.54				
50	50	15			1.93	2.54				
50	55	17.5				2.93	3.63	4.31		
50	30	15				2.23	2.75			
60	35	20							4.28	4.83
60	40	20				2.70	3.33	3.96		
60	50	15				2.86	3.53			
60	50	20				3.01	3.73	4.43		
60	60	20				3.33	4.12	4.90		
60	30	20			1.93	2.54				
70	45	24			2.38	3.14				
70	20	11			1.62	2.16				
80	40	15				2.86	3.53	4.19		
80	40	20				3.01	3.73	4.43		
80	50	10				3.01	3.73	4.43		
80	50	25					5.13	5.93		
80	60	15					4.31	5.13	5.93	
80	70	20					5.14	6.12	7.09	
80	80	30					5.70	6.78	7.86	
100	50	25				3.80	4.71	5.60		
100	60	30							7.31	8.29
100	70	35							8.13	9.23
120	30	12			2.33	3.08				
140	50	25							7.58	8.60
150	70	35						8.20	9.50	10.80
180	25	15	2.01	2.40	2.99					
180	30	15	2.09	2.50	3.11					
180	30	30	2.32	2.78	3.46					
180	40	10					5.36	6.31	7.31	
180	60	30					6.87	8.20	9.50	

arcarecci

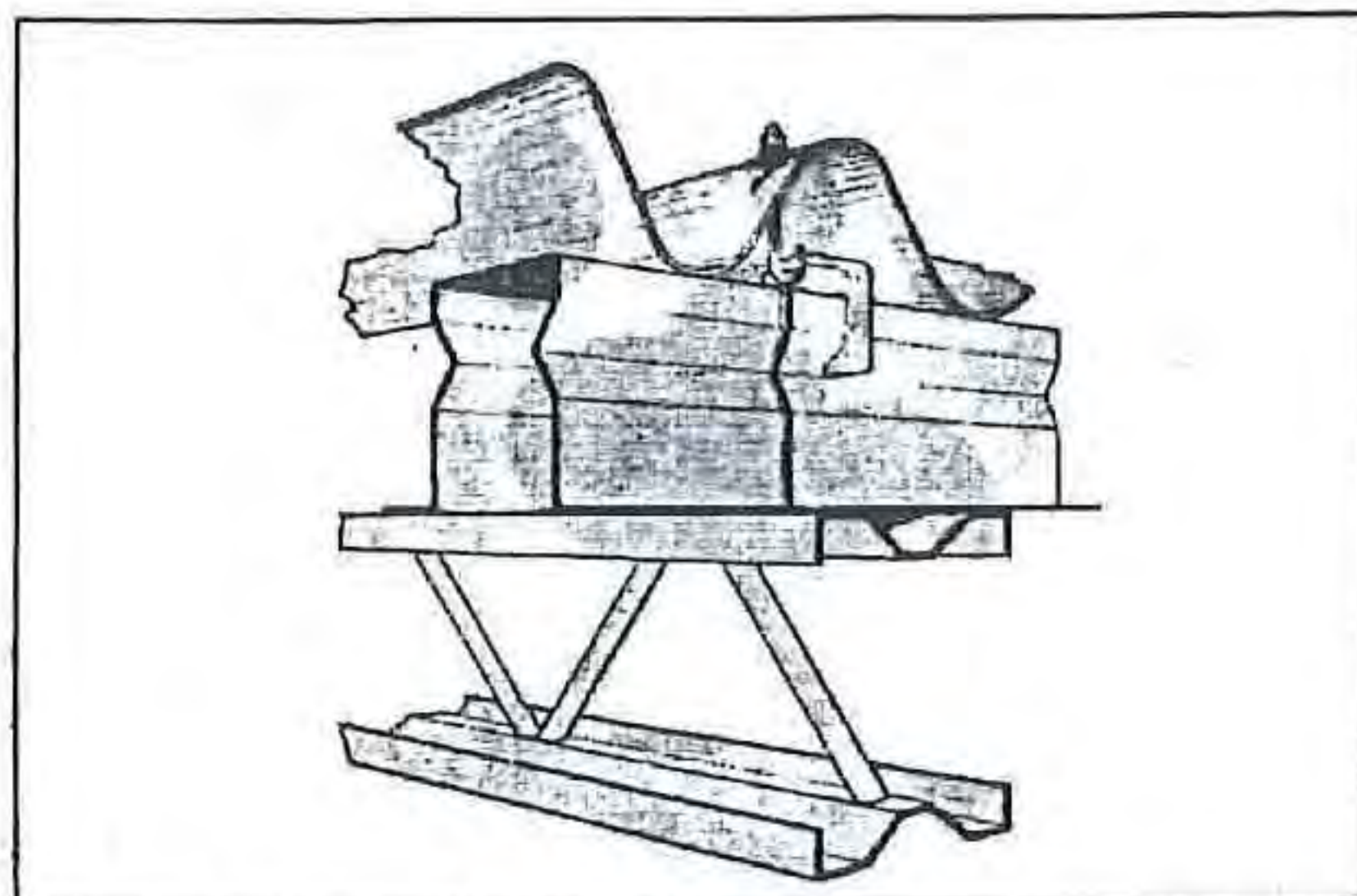

Momenti di inerzia W_x e W_y e valori dei carichi uniformemente distribuiti (incluso peso proprio della struttura) che possono portare gli arcarecci qui raffigurati.
 I carichi scritti in neretto sono relativi ad arcarecci caricati secondo l'asse « x » (solalo piano).
 I carichi scritti in corsivo sono relativi ad arcarecci caricati a 25° secondo l'asse « x » (falde tetti).
 I valori qui riportati sono verificati con carico di sicurezza 1000 Kg/cm².

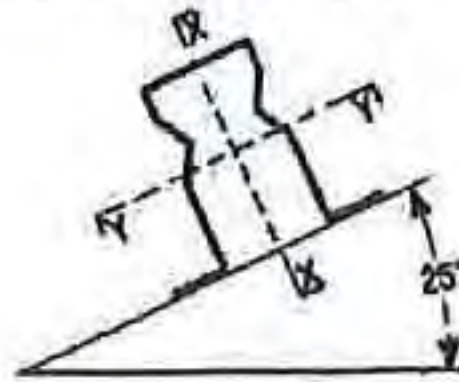

TIPO	Spess. mm/10	W_x cm ³	W_y cm ³	Carico uniformemente distribuito in Kg/ml sopportato dagli arcarecci in relazione alle distanze tra gli appoggi espresse in ml							
				1,5	2	2,5	3	3,5	4	4,5	
148	20/10	4,41	4,05	120	50						
				160	70						
149	20/10	11,20	6,32	245	140	70					
				395	220	140	100				
	25/10	14,00	7,70	290	170	120	70				
				480	275	180	130				
147	20/10	17,00	9,23	360	200	135	80				
					340	220	150	120			
	25/10	22,50	15,00		290	190	130	100			
					420	280	190	140	120		
	30/10	26,00	17,90		370	230	165	125	60		
					500	335	235	170	135	110	

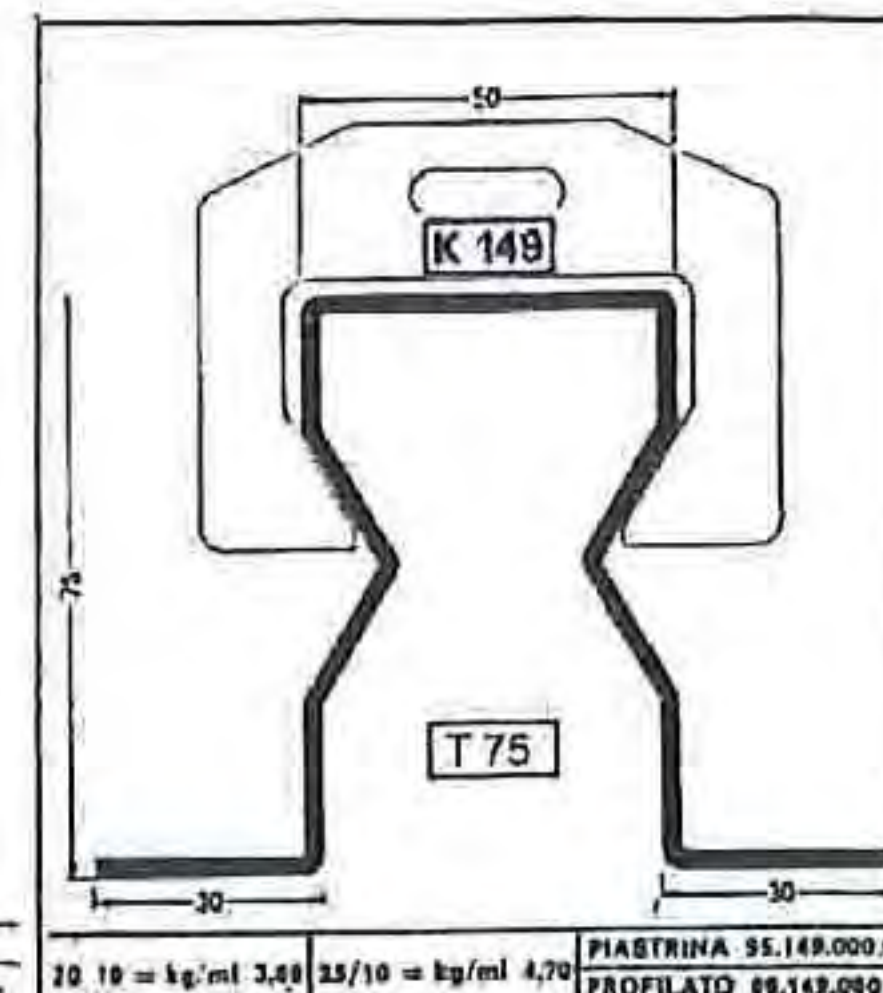
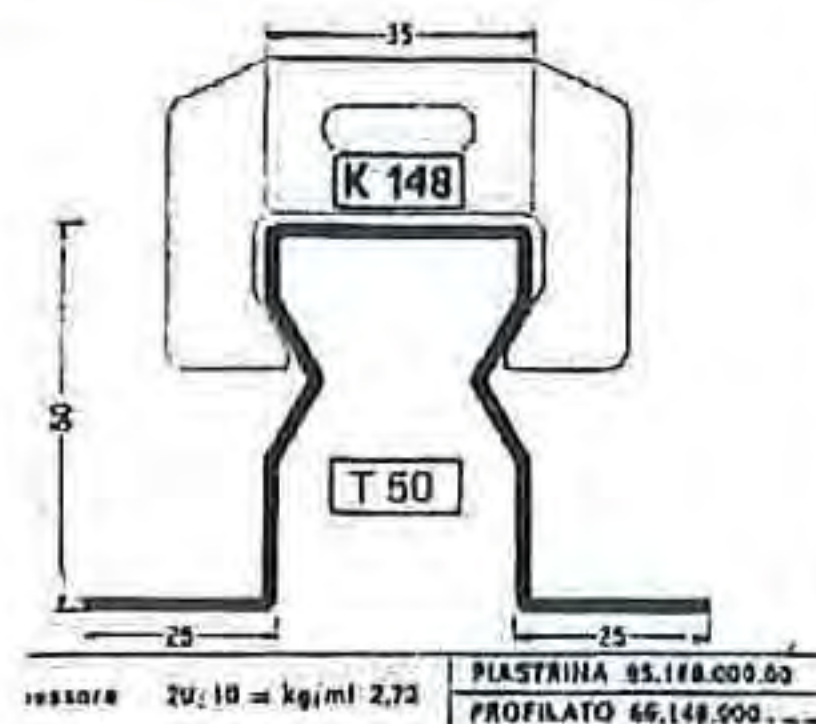
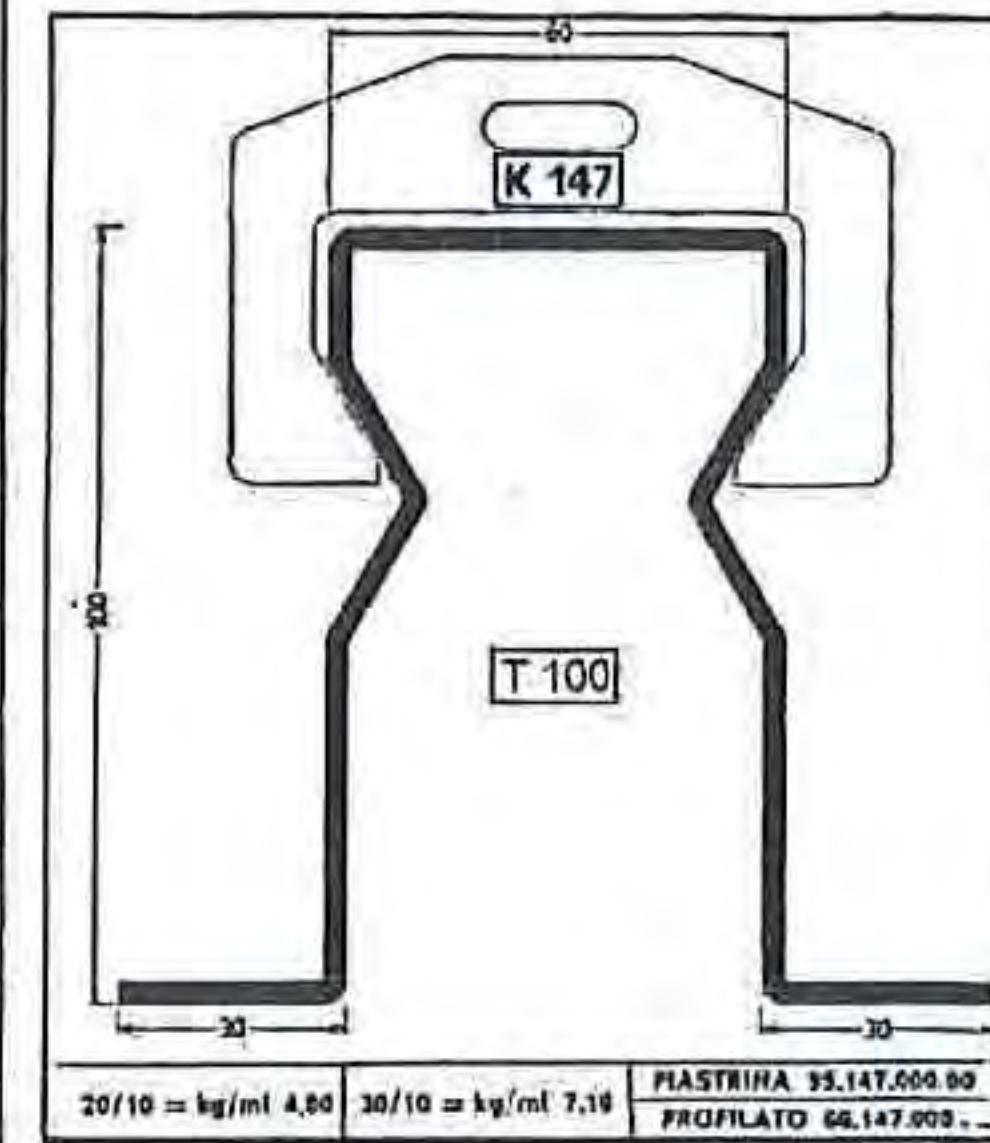
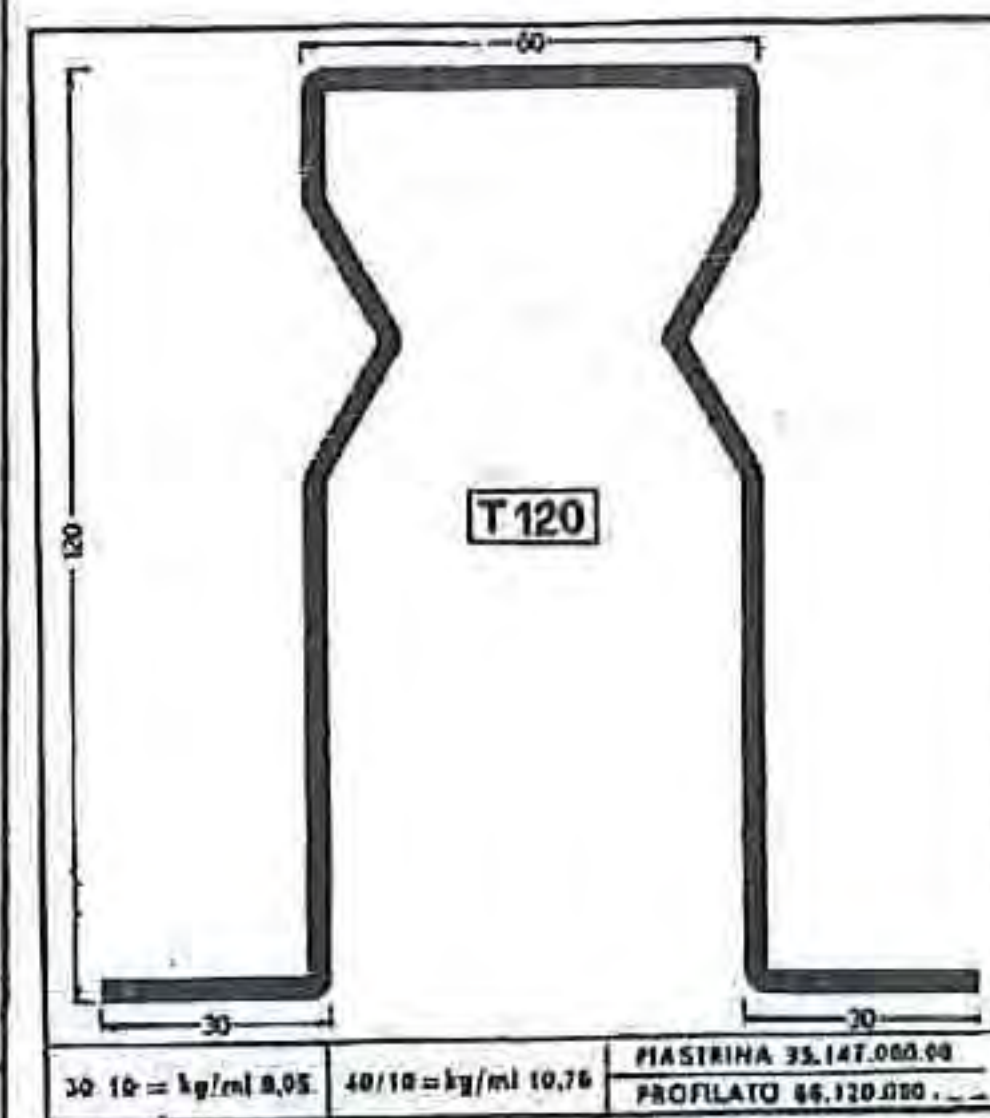

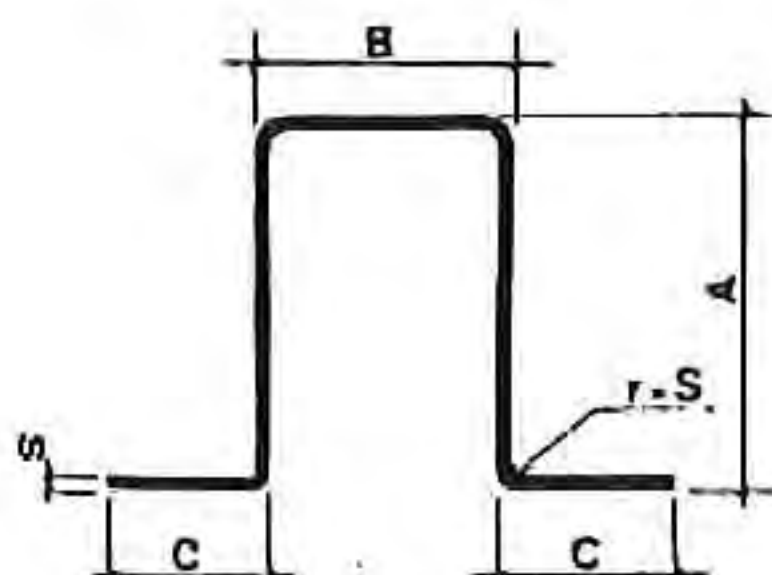

PROFILI APERTI OMEGA SIMMETRICI

dimensioni C x A x B mm	spessore						
	1,5	2	2,5	3	4	5	6
	peso kg/m						
10 x 15 x 15	0,636						
10 x 15 x 30	0,816	1,02					
10 x 20 x 20	8,16						
10 x 25 x 15	0,876	1,10					
10 x 25 x 50	1,300	1,66					
15 x 30 x 15	1,110	1,42					
15 x 30 x 30	1,300	1,66					
15 x 30 x 50	1,540	1,98					
15 x 35 x 15	1,240	1,58					
15 x 35 x 35	1,480	1,90					
20 x 35 x 20	1,410	1,82	2,20				
20 x 35 x 35	1,600	2,06	2,50	3,20			
20 x 35 x 50	1,780	2,30	2,80	3,26			
20 x 40 x 30	1,660	2,14	2,60	3,02			
25 x 40 x 25	1,720	2,22	2,70	3,14			
25 x 40 x 30	1,780	2,30	2,80	3,26			
25 x 40 x 40	1,900	2,46	3,00	3,50			
20 x 45 x 20	1,660	2,14	2,60				
20 x 45 x 30	1,780	2,30	2,80	3,26			
25 x 45 x 45	2,080	2,70	3,30	3,86			
20 x 50 x 25	1,840	2,38	2,90				
20 x 50 x 30	1,900	2,46	3,00	3,50			
20 x 50 x 50	2,130	2,78	3,40	3,98			
25 x 50 x 30	2,010	2,62	3,20	3,75			
25 x 50 x 40	2,140	2,78	3,40	3,98			
30 x 50 x 25	2,07	2,70	3,30				
30 x 50 x 30	2,13	2,78	3,40	3,98			

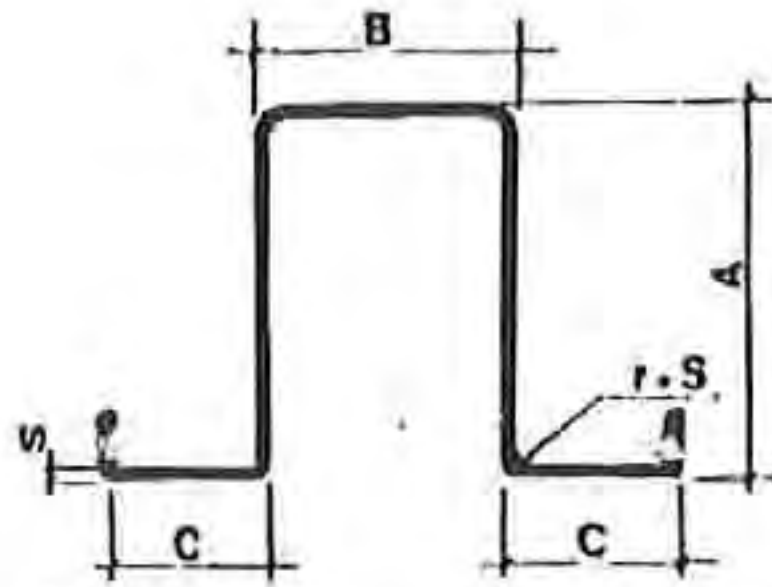

PROFILI APERTI OMEGA SIMMETRICI

dimensioni C x A x B mm	spessore						
	1,5	2	2,5	3	4	5	6
	peso kg/m						
20 x 60 x 30	2,13	2,78	3,40	3,98			
20 x 60 x 40	2,26	2,95	3,60	4,22			
25 x 60 x 30	2,26	2,95	3,60	4,22			
25 x 60 x 40	2,38	3,10	3,80	4,46			
30 x 60 x 30	2,38	3,10	3,80	4,46			
30 x 60 x 40	2,50	3,26	4,00	4,70			
20 x 70 x 25	2,31	3,02	3,70	4,34			
20 x 70 x 40	2,50	3,26	4,00	4,70			
20 x 70 x 50	2,61	3,42	4,20	4,95			
25 x 70 x 40	2,61	3,42	4,20	4,95			
25 x 70 x 50	2,73	3,58	4,40	5,18			
30 x 70 x 30		3,42	4,20	4,95			
30 x 70 x 50		3,74	4,60	5,42			
20 x 75 x 50		3,58	4,40	5,18			
25 x 75 x 50		3,74	4,60	5,42			
30 x 75 x 50		3,90	4,80	5,66			
20 x 80 x 40		3,58	4,40	5,18			
20 x 80 x 50		3,74	4,60	5,42			
25 x 80 x 40		3,74	4,60	5,42			
25 x 80 x 50		3,90	4,80	5,66			
30 x 80 x 40		3,90	4,80	5,66			
30 x 80 x 50		4,06	5,00	5,90			
15 x 100 x 30		3,90	4,80	5,66			
25 x 100 x 40		4,38	5,40	6,38			
25 x 100 x 50		4,54	5,60	6,62			
25 x 100 x 60		4,70	5,80	6,84			
30 x 100 x 40		4,54	5,60	6,62			
30 x 100 x 50		4,70	5,80	6,84			
30 x 100 x 60		4,86	6,00	7,10			
40 x 100 x 40		4,86	6,00	7,10			
30 x 110 x 50		5,02	6,20	7,34			
30 x 120 x 50		5,34	6,60	7,82	10,18		
30 x 120 x 60		5,50	6,80	8,06	10,50		
40 x 120 x 80		6,14	7,60	9,03	11,77		
30 x 150 x 80		6,78	8,40	9,98	13,06	16,00	
40 x 150 x 80		7,10	8,80	10,46	13,70	16,80	
40 x 150 x 110		7,58	9,40	11,18	14,66	18,00	